



De Warrene Court, Norfolk, IP26 4RT

Rent - £300,000 Deposit -

A well presented modern detached 3 bedroom bungalow residence with garage pleasantly situated in a small cul-de-sac within the Norfolk village of Methwold. The property benefits from comfortable, contemporary accommodation throughout and an early viewing is recommended.

Agent's Note:

Please be aware that images of the property may have been digitally enhanced, edited, or staged using artificial intelligence, and may not reflect the current presentation or furnishings.

- CONSTRUCTED APPROXIMATELY 5 YEARS AGO
- EDGE OF VILLAGE
- LIVING ROOM/ KITCHEN
- THREE BEDROOMS PLUS EN-SUITE
- UNDERFLOOR AIR SOURCE HEATING
- MODERN DEVELOPMENT OF HOMES
- CONTEMPORARY FITTINGS THROUGHOUT
- SEPARATE UTILITY ROOM
- UPVC DOUBLE GLAZING
- GARAGE, EXTENSIVE PATIO & ENCLOSED GARDENS



Council Tax Band: D - EPC Rating: B 85

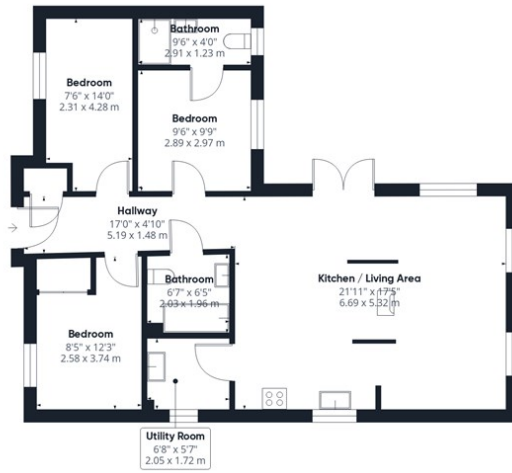

Ground Floor Building 1



Ground Floor Building 2

Approximate total area⁽¹⁾
 1129 ft²
 104.8 m²

(1) Excluding balconies and terraces

Calculations reference the RICS IPMS
 3C standard. Measurements are
 approximate and not to scale. This
 floor plan is intended for illustration
 only.

GIRAFFE 360

